

THE EQUIPMENT

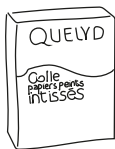

Glue for non-woven wall paper



A plastic bowl for the glue

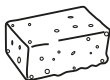

A barely damp sponge

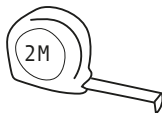

A tape measure



A bubble level



A metal rule



A paste block brush

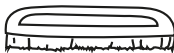

A paper Hanger Brush



An external Corner wallpaper Seam Roller



A craft knife with a new blade

THE WALLPAPERING

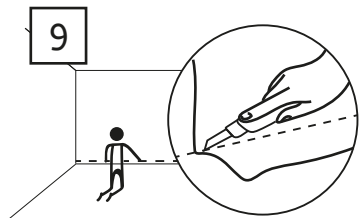
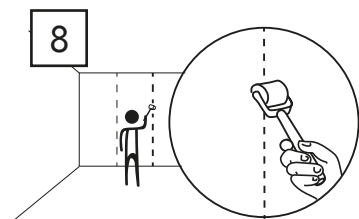
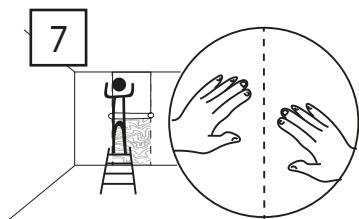
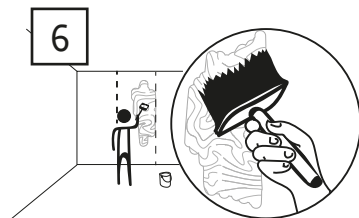
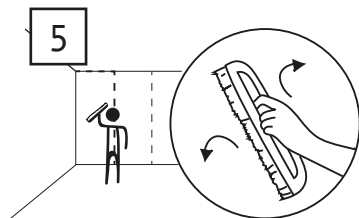
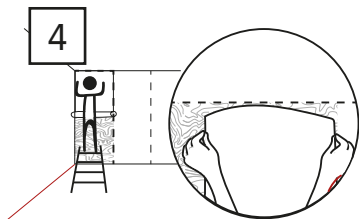
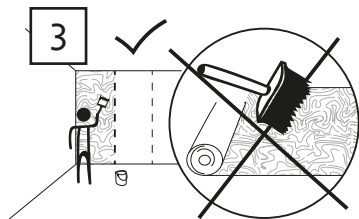
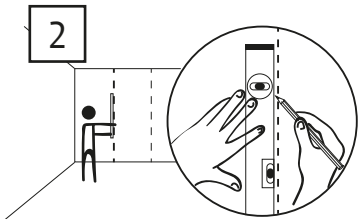
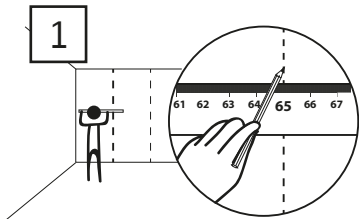

BRAVO !!!

THE WALLPAPERING / DETAILS

BEFORE HANGING THE WALLPAPER :

Remove all old covering or lightly sand the painted wall for to allow the best possible adherence of the glue. The walls must be clean and dry and smooth and uniform. For the lightest models, it's important to have a white and plain wall in order to have a perfect result.

1

Trace your laying marks on the wall with a tape measure.

2

Make sure your lines are vertical using a bubble level or a plumb line.

3

Once your lines are placed, prepare the glue and apply it directly on the wall with a paste block brush (don't go outside the zone).

4

Unwind the roller from top to bottom without having cut and place it on the wall.

5

Push the air from the back of the wallpaper with the paper hanger brush : make gestures from the center to the outside of the strip.

6

Repeat the process for your second strip applying the glue directly on the wall.

7

Apply strips edge-to-edge and at the same level for a perfect repeat. (Be careful! It's important to be rigorous and to leave no space between the strips in order to have an optimal rendering.)

8

Pass an external corner wallpaper seam roller over the edges of the strips so that they stick well to the wall.

9

Cut the strips at the bottom of the wall with a metal rule and a craft knife with a new blade.

Here we are, your Trait Francais wallpaper is hung on!